

Two models.

One intelligent generation.

Our new WD-6S and WD-7S take everything that was great before and make it even better – with improved energy efficiency, easier handling, and a fresh ergonomic design adapted for real kitchen performance.



WD-6S

Smart. Compact.
Efficient.

Available from
October 2026.



WD-7S

Powerful. Spacious.
For higher capacity.

Available from
September 2026.

** Both machines are available
with automatic hood lifting.*

SHARED KEY FEATURES



Automatic hood lift and auto start

Automatic hood opening with ergonomic operation and redesigned lifting arms for stable and reliable performance.



Front service access

Fast servicing, minimal operational downtime.



Two-stage energy saving function

Reduces energy consumption between wash cycle



40 % lighter rinse arms

Improved rinsing process. New and updated rinse arms.



4,3" touch-screen

Intuitive, durable and informative.



Intuitive rinse function

Enhanced functionality together with the new touch panel.

Robust design

A robust design built for a long service life.

ECO-FLOW (optional)

Saves energy and accelerates drying.

Ergonomic hood

Directs steam away from the operator.

More than 70,000 WD-6 units are in operation worldwide — valued in small and medium-sized dishwashing rooms for their durability, user-focused design and low operating costs.



Built for a better tomorrow

Up to 98% recycled stainless steel – for a longer service life and reduced environmental impact.

WD-6S

HOOD TYPE DISHWASHER

FEATURES

- Robust and reliable design in stainless steel with components that guarantee a durable and reliable operation for many years
- The machine has an energy saving heat and sound insulating double-skinned hood.
- A good working environment with the unique hood concept
- High levels of hygiene with an automatic cleaning programme and guaranteed rinse temperature by thermal stop system
- Self-drained wash pump
- Large deep tank to protect against foaming
- Easy servicing - the machine is serviced from the front
- Hygiene control – control system with integrated HACCP
- Excellent wash results – with selfdraining washing arms
- Powerful washing pressure with anti-blocking nozzles
- Individual adjustable wash- and rinse times as well as temperatures for each programme
- Inbuilt dosing pump for fine dosage of rinse aid
- Automatic cleaning program



OPTIONS

- Automatic hood
- Autostart for automatic hood
- 230V/1/50Hz
- 230V/3/50Hz
- Marine version
- Detergent pump for liquid detergent
- Side-mounted panel
- Lockable cabinet for chemicals (not in comb. with break tank or panel on left side)
- Booster heater for cold water connection
- Drain pump
- Separate filling of tank
- Break tank with booster pump (to be used when no external resuction protection is mounted)
- Booster pump connected with WD-PRM6 equipped with automatic hood (In combination with break tank)
- ECO-FLOW condensing unit with heat recovery by the exhausted steam. (cold water connection is required)
- Heat exchanger with heat recovery by the drain water. Not in combination with PRM. (cold water connection is required)
- WEB Tool - For external HACCP documentation

EXTRA EQUIPMENT

- Steam hood with suction connection
- Shelf for chemical storage
- Sideboard (560 x 560 mm)

TECHNICAL DATA	WD-6S
Wash pump (kW)	0.9
Booster heater (kW)	9/12*
Heater tank (kW)	1.8
Tank volume (litres)	50
Weight, machine in operation (kg)	160
Degree of protection (IP)	45

* 12 kW booster heater is optional.

CAPACITY AND OPERATION DATA	WD-6S
Total time/wash program 1 (min)	1.2**
Total time/wash program 2 (min)	1.7**
Total time/wash program 3 (min)	3.2**
Capacity, max (baskets/h)	50
Water consumption rinse/program (litres)	2.5-4***
Energy consumption (kWh of connected power)	70-90%
Sound level* (dB(A))	60

* Measured 1 metre from the machine.

** Factory setting. The wash time is adjustable.

*** The water consumption depends on local conditions. An exact adjustment is made during installation.

CONNECTION, MACHINE	WD-6S
Total connected power (kW)	9.9/12.9*
Main fuse 400V 3N~ (A)**	16/25*
Max connection area 400V 3N~(L1-L3, N, PE) Cu (mm2)***	2.5

* 12 kW booster heater is optional.

** Other voltages on request.

*** Cabel 2.5m H07RN-F included.

Wexiödisk

CONNECTION WATER, DRAIN AND VENTILATION	WD-6S
Water quality, hardness (°dH)	2-7
Water connection 5-65°C (external thread)*	R 1/2"
Drain connection, PP pipe (ø mm)	50
Water capacity, pressure (kPa)	180**
Water capacity, flow (litres/min)	18
Water capacity hood lift, pressure (kPa)	180**
Floor drain, capacity (litres/sec)	3
Heat load to the room (total, sensible, latent) (kW)	2.3 / 1.7 / 0.6
For machines with the option ECO-FLOW: heat load to the room (total, sensible, latent) (kW)	1.2 / 0.9 / 0.3

* If colder water than 55° C a 12 kW booster heater is recommended.

** If pressure / flow is lower the machine should be equipped with a break tank.

SIZE AND WEIGHT FOR TRANSPORTATION	WD-6S
Size LxWxH (mm) *	765x710x1560
Weight (kg) *	115

* Packaging included.

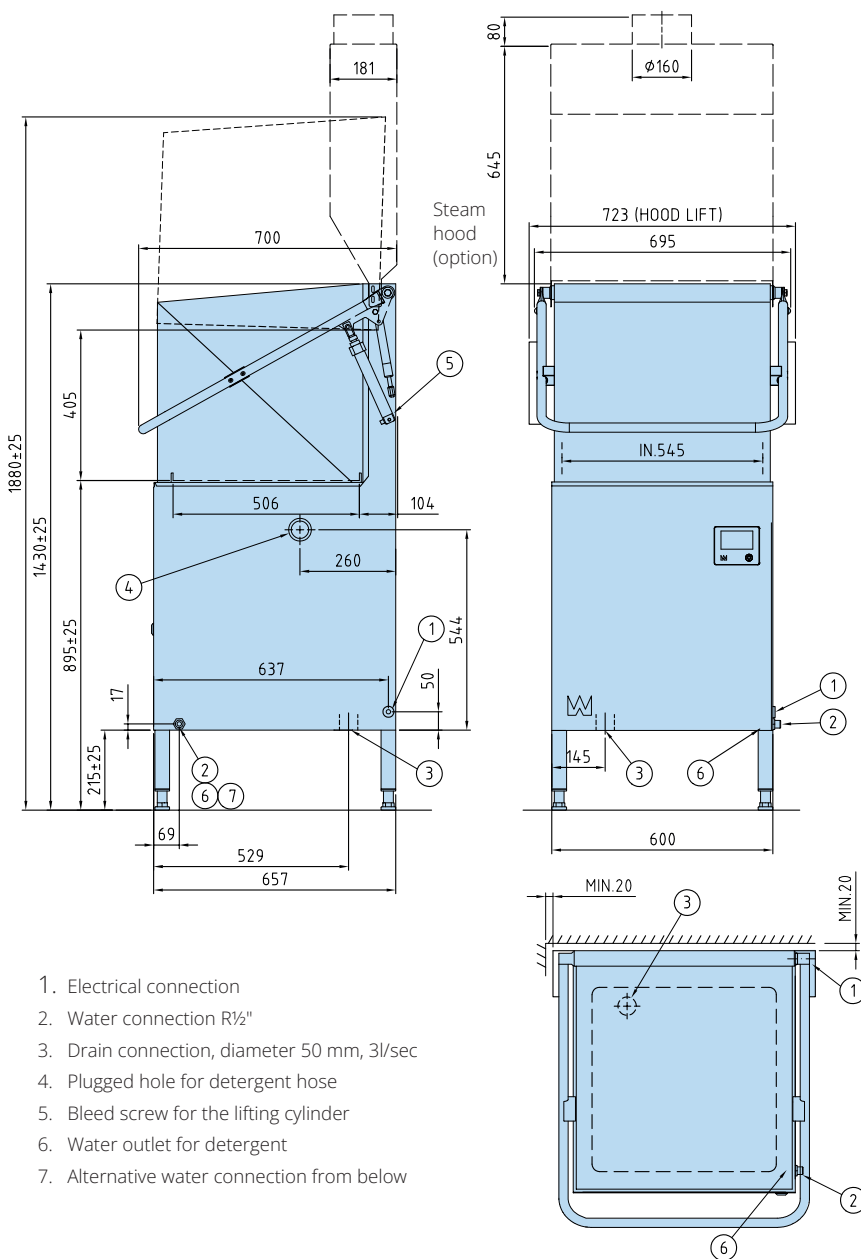

WD-6S with **ECO-FLOW** condensing unit and heat exchanger

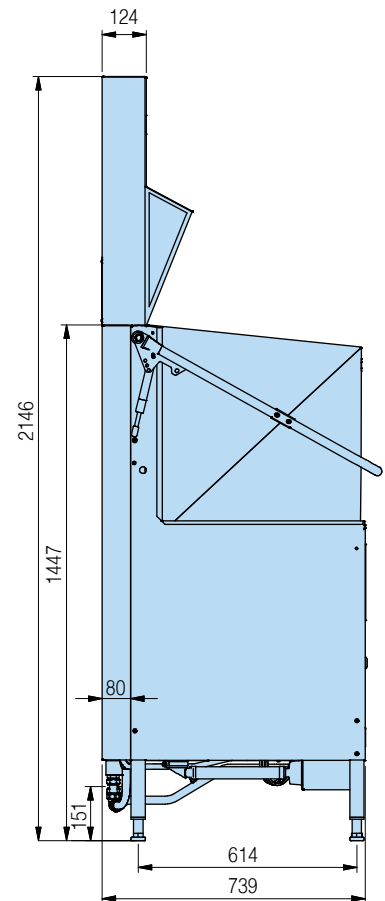

Wexiödisk



WD-7S

HOOD TYPE DISHWASHER

FEATURES

- Unique and flexible washing system. The machines water pressure can be reset quickly and easily between normal and heavily soiled settings
- Robust and reliable design in stainless steel with components that guarantee a durable and reliable operation for many years
- Thanks to the adjustable water pressure you can easily switch between normal and heavily soiled loads.
- The machine has an energy saving heat and sound insulating double-skinned hood
- A good working environment with the unique hood concept
- High levels of hygiene with an automatic cleaning programme and guaranteed rinse temperature by thermal stop system
- Self-drained wash pump
- Large deep tank to protect against foaming
- Easy servicing - the machine is serviced from the front
- Hygiene control – control system with integrated HACCP
- Excellent wash results – with selfdraining washing arms
- Powerful washing pressure with anti-blocking nozzles
- Individual adjustable wash- and rinse times as well as temperatures for each programme
- Inbuilt dosing pump for fine dosage of rinse aid
- Automatic cleaning program



OPTIONS

- Automatic hood
- Autostart for automatic hood
- 230V/1/50Hz
- 230V/3/50Hz
- Marine version
- Detergent pump for liquid detergent
- Side-mounted panel
- Lockable cabinet for chemicals (not in comb. with break tank or panel on left side)
- Booster heater for cold water connection
- Drain pump
- Separate filling of tank
- Break tank with booster pump (to be used when no external resuction protection is mounted)
- Booster pump connected with WD-PRM7 equipped with automatic hood (In combination with break tank)
- ECO-FLOW condensing unit with heat recovery by the exhausted steam. (cold water connection is required)
- Heat exchanger with heat recovery by the drain water. Not in combination with PRM. (cold water connection is required)
- WEB Tool - For external HACCP documentation

EXTRA EQUIPMENT

- Connection pipe with non-return valve and vacuum valve
- Steam hood with suction connection
- Shelf for chemical storage
- Sideboard (560 x 560 mm)
- Rack for 8 pcs baking plates
- Special rack for containers

TECHNICAL DATA	WD-7S
Wash pump (kW)	1.1
Booster heater (kW)	9/12*
Tank heater (kW)	1.8
Tank volume (litres)	50
Weight, machine in operation (kg)	170
Enclosure class (IP)	45

* 12 kW booster heater is optional.

CAPACITY AND OPERATING DATA	WD-7S
Total washing time P1 (min)	1.2**
Total washing time P2 (min)	1.7**
Total washing time P3 (min)	3.2**
Max. capacity, baskets/hour (no.)	50
Water consumption rinsing/programme (litres)	2.5-4***
Energy consumption (% of connected power)	70-90%
Sound level (dB(A))*	62/60

* Measured 1 metre from the side of the machine.

** Factory setting. The washing time can be adjusted.

*** The water consumption depends on local conditions. An exact adjustment is made during installation.

CONNECTION, MACHINE	WD-7S
Total connected power (kW)	10.1/13.1*
Main fuse 400V 3N~ (A) **	16/25*
Max. connection area 400-415V 3N~ (L1-L3,N,PE) Cu (mm ²) ***	2.5

* With 12 kW booster heater (optional).

** Other voltage on request.

*** Cable 3 m H07RN-F is included.



WATER, DRAIN AND VENTILATION CONNECTIONS	WD-7S
Water quality, hardness (°dH)	2 - 7
Water connection 5-65°C (external thread)*	R ½"
Drain connection, PP pipe (ø mm.)	50
Water capacity, min/max pressure (kPa)	180**
Water capacity, flow (litres/min)	18
Water capacity hood lift, pressure (kPa)	300**
Floor drain, capacity (litres/sec)	3
Heat load to the room (total, sensible, latent) (kW)	2.3 / 1.7 / 0.6
For machines with the option ECO-FLOW: heat load to the room (total, sensible, latent) (kW)	1.2 / 0.9 / 0.3

* If colder water than 55°C a 12 kW booster heater is recommended.

** If pressure/flow is lower the machine should be equipped with a break tank.

SIZE AND WEIGHT FOR TRANSPORTATION	WD-7S
Size, LxWxH (mm.) *	765x805x1650
Weight (kg) *	125

* Packaging included

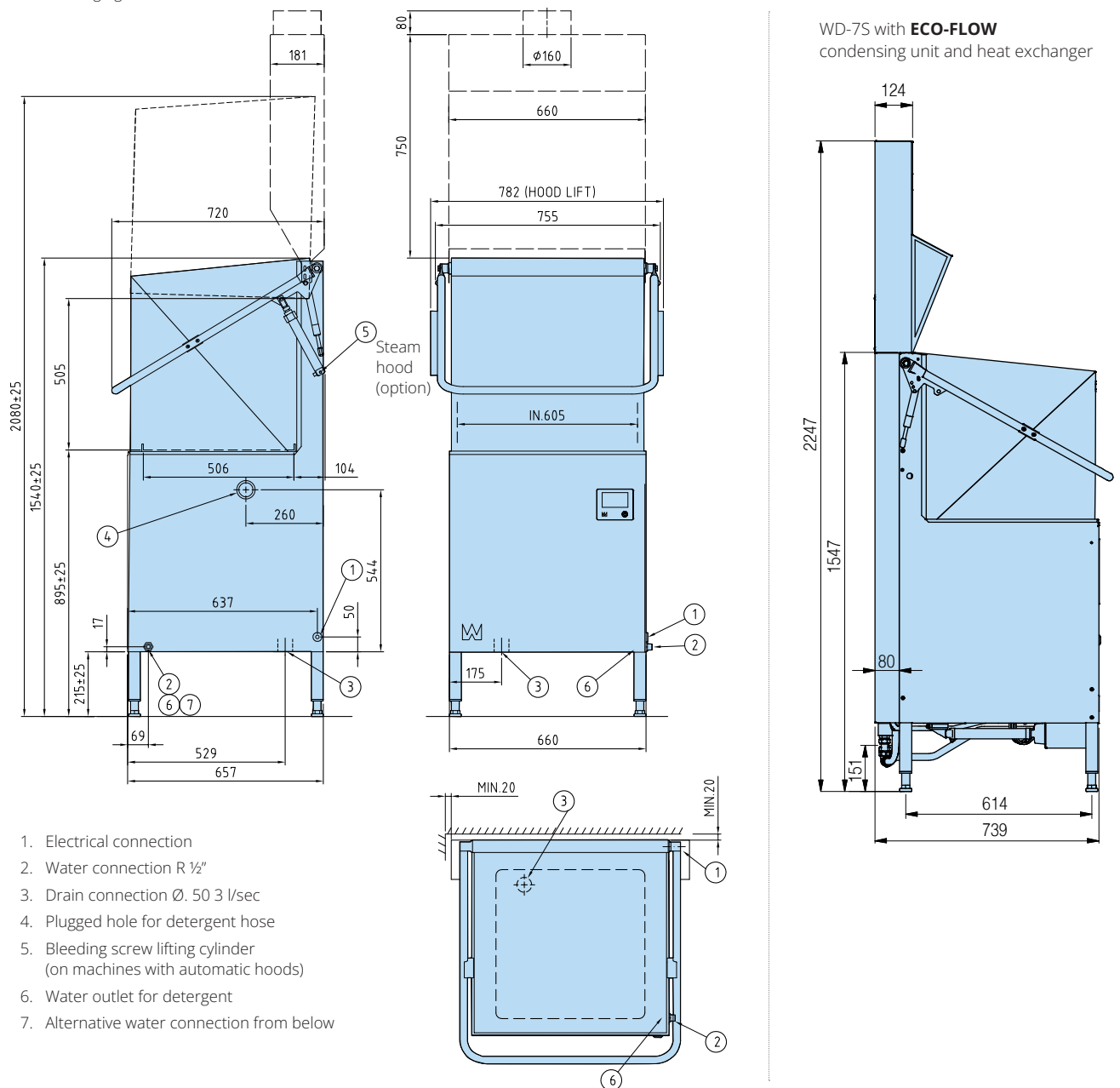

Wexiödisk

TELEPHONE: +46 470 77 12 00 FAX: +46 470 237 52 ADDRESS: Mårdvägen 4 SE-352 45 Växjö SWEDEN
 E-MAIL: wexiodisk@wexiodisk.com WEBB: www.wexiodisk.com